

**MATERIAL**

Stainless steel, matte finish.

AISI 304 stainless steel screws and nuts.

Polyamide based (PA) or polytetrafluoroethylene based (PTFE) technopolymer sliding bushings.

**FEATURES AND APPLICATIONS**

GN 131.2-NI connecting clamps can normally be matched with the linear actuators.

By clamping the guide holes d1/d2 it is possible to adjust the actuator positioning and to lock the slider after having set up the final position.

The clamping screws d3 may be replaced by clamping kits GN 911 (see page 1958).

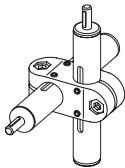

- 1
- 2
- 3
- 4
- 5
- 6
- 7
- 8
- 9
- 10
- 11
- 12
- 13
- 14
- 15
- 16
- 17
- 18

Conversion Table	
1 mm = 0.039 inch	
d1	
mm	inch
18	0.71

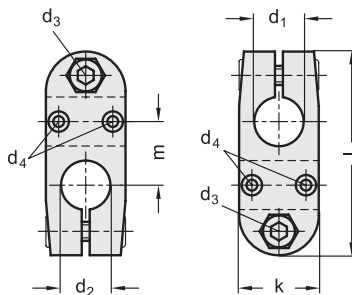

Code	Description	d1##	d2##	d3	d4	k	l	m	d3 Clamping kit	⚖
GN.42313	GN 131.2-G18-G18-2-NI	18	18	M6	M3	25	64	20	GN 911-M6-22	148

## Hole with sliding bushing.